

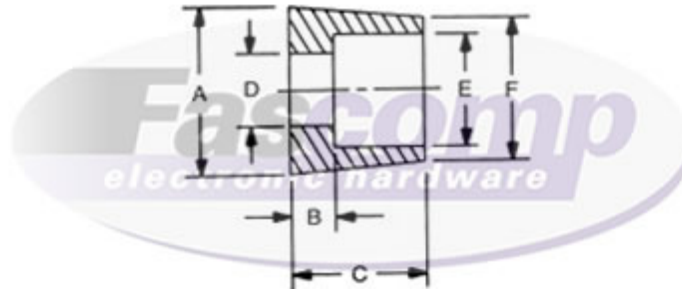

Ferrules Type 4



Create a part number:		
Length	Material	Finish
FCXXXX	XX	XX
_____ - _____ - _____		

Part Number							
✓	FCXXXX	A +.005 -.005	B +.005 -.005	C +.005 -.005	D +.005 -.005	E +.005 -.005	F +.015 -.015
	FC8994	9/16	.093	.312	.203	.323	7/16
	FC8995	5/8	.125	.437	.281	.390	7/16
	FC8996	3/4	.187	.562	.328	.510	19/32

Material	
✓	Material Code (XX)
	A Aluminum
	B Brass
	S Steel
	SS Stainless Steel

✓	Compatible Finish	
	A, B, S, SS	0 - Plain
	B, S	5 - Nickel Plate (QQ-N-290)
	A	6 - Iridite #14 Gold (MIL-C-5541E)
	A	7 - Iridite Clear (MIL-C-5541E)
	A	9 - Alodine 1200
	B, S	12 - Zinc Clear (ASTM-B-633)
	B, S	16 - Electro Tin (MIL-T-10727 TYPE 1)
	SS	20 - Passivation (MIL-F-14072D)
	A	22 - Clear Anodize (MIL-A-8625-TYPE2) (Sulphuric) Hot Water Seal (Clear)
	A	24 - Black Anodize (MIL-A-8625)
	B, S, SS	26 - Black Oxide
	B, S	28 - Zinc Yellow (ASTM-B-633)

**Tolerances
Unless otherwise Specified**
 .xxx +/- .005
 .xx +/- .010
 Angular +/- 1 Degree
 Linear +/- .005
Break all sharp edges



Source Control Drawing:
To be produced by
Fascomp Electronic Hardware

This document is the property of Fascomp Inc. and shall not be reproduced, distributed or used as a basis for manufacturing without written permission from Fascomp Inc.